

MSU Concrete Walk Standard

Concrete Sidewalks: Concrete Sidewalks shall have a 28 day compressive strength of 3500 psi. Concrete shall be placed with maximum slump of 3 inches. Expansion Joints shall be placed not to exceed 40 feet. All sidewalks shall have continuous steel reinforcing #4 or better at 24" on center each way. Steel rebar shall run continuous thru expansion joints.

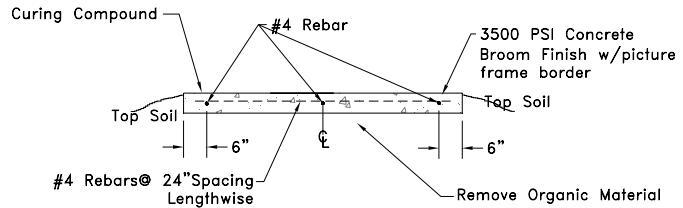

Typical Sidewalk Section

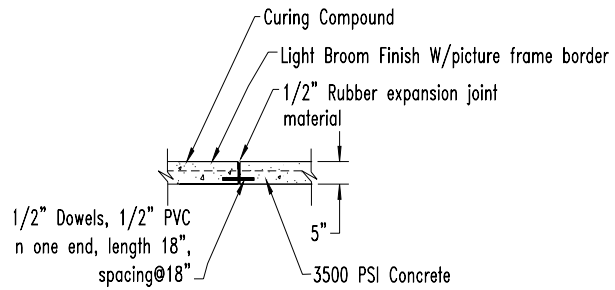

Typical Expansion Joint Section@60'

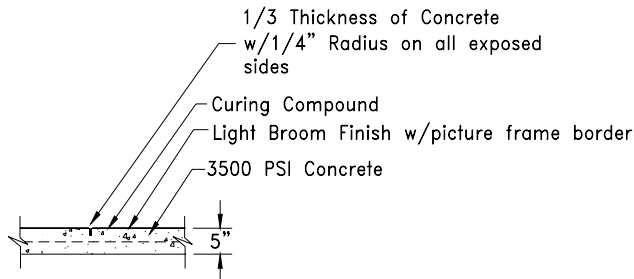

Typical Sidewalk Score Joint Section

